

## Facilities Fact Sheet

The Alisal is among the West's most sought-after destinations for group meetings and corporate retreats. With 6,000 sq. ft. of diverse meeting space, our secluded locale and excellent facilities make meeting here both a relaxing and productive experience. At the Alisal, event planners find a wide variety of unique meeting, recreational, and dining locations. This allows us to cater many types of indoor functions, from board meetings to gala social events and lavish theme dinners to unique outdoor locales for groups of all sizes. Our banquet and culinary staff is able to create memorable dining experiences at numerous indoor and outdoor venues.



### Outdoor venues include:

- **Lakeside:** Our lakeside deck is the perfect site for a fabulous seafood barbecue.
- **Rodeo:** Our rodeo arena is a great spot to host an authentic western barbecue following your group's private rodeo event.
- **Creekside:** For a slightly more elegant affair, our poolside pavilion and creek side garden provide lovely settings.
- **Wineries:** If you are willing to extend beyond the boundaries of the Ranch, we can also create a special winemaker's dinner at many of the area's outstanding wineries.

### We have four indoor meeting locations displayed below:

#### **Sycamore Room ~**

Sycamore Room, seating 200, is fashioned with high-beamed ceilings, majestic stone hearth and wood mantle, expansive windows and ceiling which allows for plenty of natural light, making it a popular choice for mid-sized meetings.

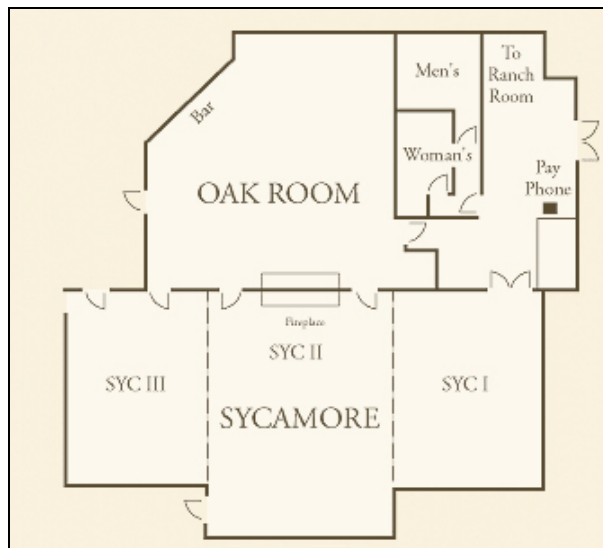

\* with dance floor – 175

<b>Dimensions</b>	<b>35' w x 80' 1</b>
<b>Square Feet:</b>	<b>2,800</b>
<b>Portable Walls:</b>	<b>Yes</b>
<b>Carpeted:</b>	<b>Yes</b>
<b>Capacities:</b>	
Theater	200
Classroom	80
U-shaped	50
Dining capacity	200*
<b>Popular Uses</b>	Large Meetings, Receptions
<b>Location</b>	Main dining area

**Cottonwood Room ~**

Ideal for larger meetings, the handsome 1,200 sq. ft. western-themed Cottonwood Room is appointed with hardwood floors, Navajo-style painted living-room style seating, a wood-burning fireplace, private bar and an abundance of natural light.

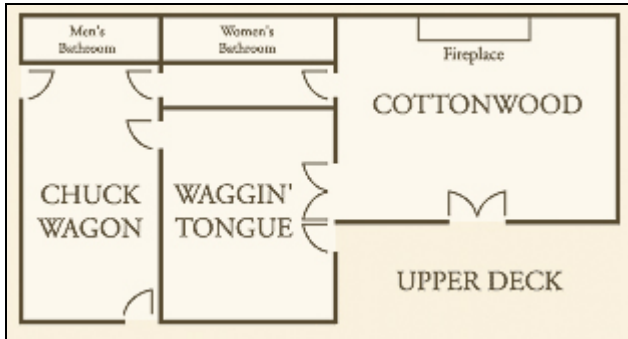

<b>Dimensions</b>	<b>40' w x 30' 1</b>
<b>Square Feet:</b>	<b>1,200</b>
<b>Capacities:</b>	
Theater	90
Classroom	60
U-shaped	35
<b>Popular Uses</b>	Private BBQ's, Luncheons, Meetings
<b>Location</b>	Upper deck overlooking the pool

**Adobe ~**

The 750 sq. ft. Adobe Room is ideal for smaller meetings with its paneled walls, high-beamed ceilings, plush carpeting, timber mantle, fireplace and aged, hewn wood furnishings. The historic Old Adobe is also an ideal location for breakout sessions.

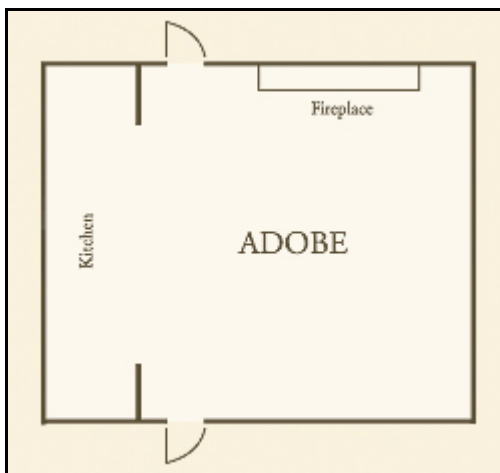

<b>Dimensions</b>	<b>22' w x 34' 1</b>
<b>Square Feet:</b>	<b>750</b>
<b>Portable Walls:</b>	<b>Yes</b>
<b>Carpeted:</b>	<b>Yes</b>
<b>Capacities:</b>	
Causal Meeting	10
Dining	20
Receptions	75
Breakfast Rides & Barbeques	150
<b>Popular Uses</b>	Small & large events
<b>Location</b>	Alisal hills

**Library ~**

For smaller conferences, the intimate Library features a large stone hearth with wood mantle, living-room style seating and private bar.

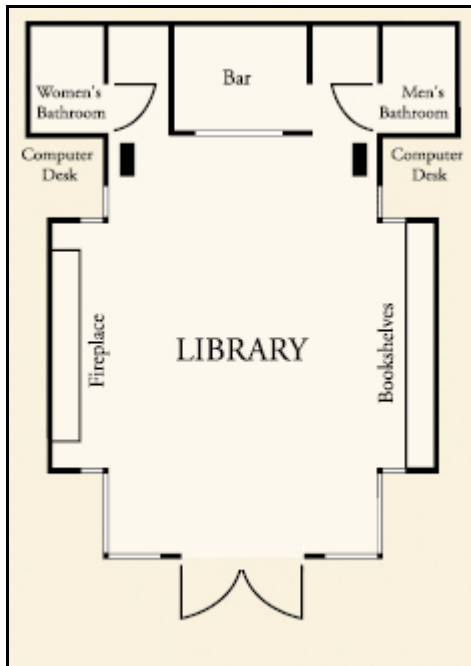

<b>Dimensions</b>	<b>22' w x 34' 1</b>
<b>Square Feet:</b>	<b>748</b>
<b>Capacities:</b>	<b>50</b>
<b>Popular Uses:</b>	Small private meetings, Receptions
<b>Location:</b>	Across for main dining room

**Thank you for considering Alisal Guest Ranch & Resort for your next meeting or event destination.**  
 If you have questions or would like to inquire about availability, please contact the Group Sales Department:  
[sales@alisal.com](mailto:sales@alisal.com) or call directly at 805-686-7613.